

UNIT, DIRECT SUPPORT, AND GENERAL SUPPORT MAINTENANCE
REPAIR PARTS AND SPECIAL TOOLS LIST

EXTENDED SERVICE PROGRAM (ESP)

TRUCK, CARGO, 2-1/2-TON, 6X6, M44A3 SERIES TRUCKS (DIESEL)

M35A3, W/O WINCH (NSN 2320-01-383-2047); W/WINCH (NSN 2320-01-383-3850);

M35A3C, W/O WINCH (NSN 2320-01-383-2050); W/WINCH (NSN 2320-01-383-2049);

M36A3, W/O WINCH (NSN 2320-01-383-2048); W/WINCH (NSN 2320-01-383-2046).

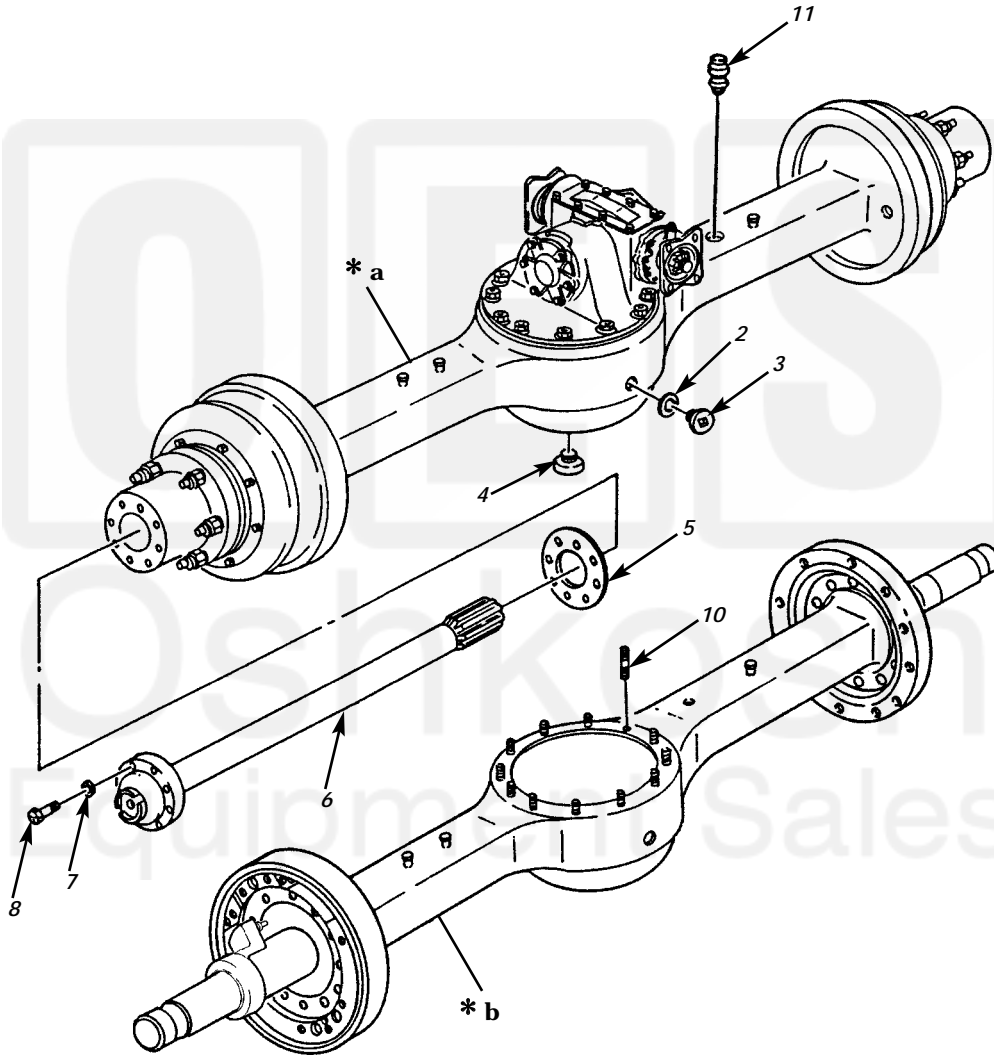
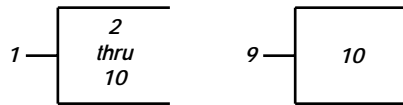

* a PART OF ITEM 1

* b PART OF ITEM 9

Figure 104A. Forward-Rear and Rear-Rear Axle Assembly.

Current part is item (6) on diagram. Available at www.oshkoshequipment.com

(1) ITEM NO	(2) SMR CODE	(3) NSN	TM9-2320-386-24P (4) CAGEC	(5) PART NUMBER	(6) DESCRIPTION AND USABLE ON CODES(UC)	0105 01 (7) QTY
GROUP 11 REAR AXLE						
1100 REAR AXLE ASSEMBLY						
FIG. 104A FORWARD-REAR AND REAR-REAR AXLE ASSEMBLY						
1	PAFHH	2520014149124	34623	RCSK-15147	AXLE ASSEMBLY,AUTOM.....	2
2	PAOZZ	5330005143289	96906	MS35769-21	.GASKET.....	1
3	PAOZZ	5365007326126	19207	7326126	.PLUG,MACHINE.....	1
4	PAOZZ	4730005954827	78500	1250Z182	.PLUG,PIPE,MAGNETIC.....	1
5	PAOZZ	5330005994230	19207	7521787	.GASKET.....	2
6	PAOZZ	2520007521730	19207	7521730	.SHAFT,AXLE,AUTOMOTI.....	2
7	PAOZZ	5310005845272	96906	MS35338-48	.WASHER,LOCK.....	16
8	PAOZZ	5306001829267	19207	10896726	.BOLT,MACHINE.....	16
9	PAOOO	2520014145091	19207	12448527	.AXLE ASSEMBLY,AUTOM HOUSING.....	1
10	PAFZZ	5307002077596	19207	7521785	..STUD,PLAIN.....	12
11	PAOZZ	4820007264719	19207	5196397	VALVE,VENT.....	1

END OF FIGURE

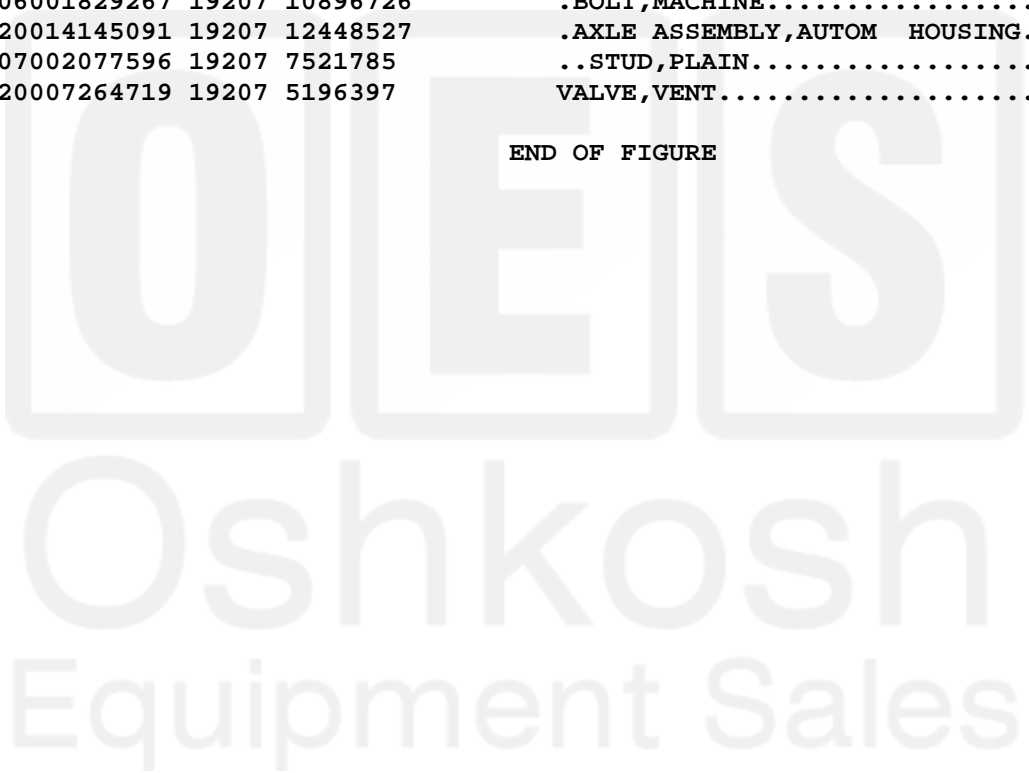

Current part is item (6) on diagram. Available at www.oshkoshequipment.com